

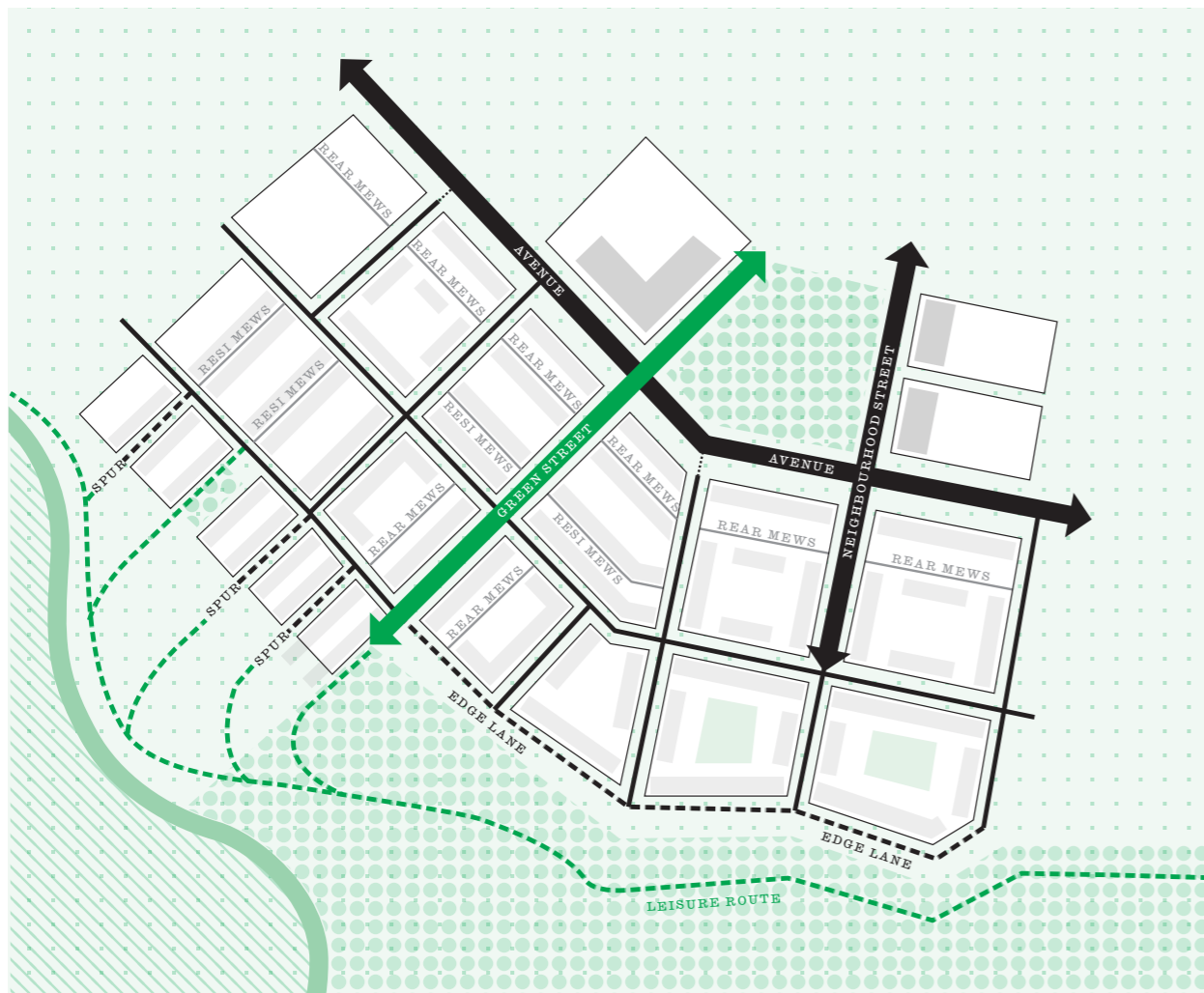

SELECTING STREET TYPES

The character of streets are central to creating legible neighbourhoods. The code sets out eight street types that must be used together to create a connected network of routes. Larger development sites are likely to require more of the eight street types than smaller sites which may only need one or two.



ST01.01

The selection of street types within a development must be in accordance with the diagram below which sets out the decision-making process.

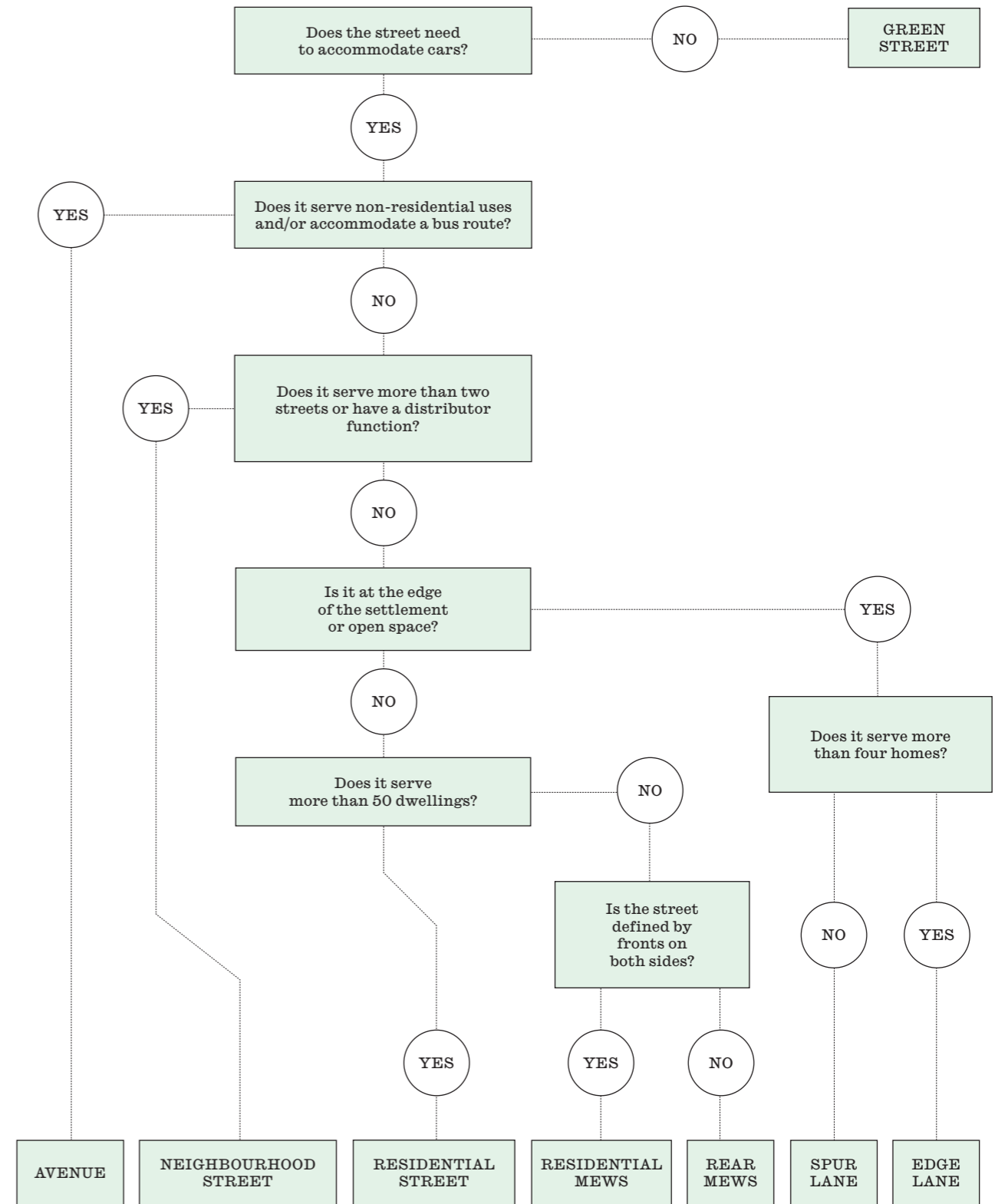

STREET DESIGN

The following codes apply to all eight street types and must be read in conjunction with the street-specific codes on the next pages which are organised by place, movement, parking and technical requirements.

STO2.01 – HCC PMPDG Status

Street designs must be based on Hertfordshire County Council's Place and Movement Planning Design Guide (HCC PMPDG) which is a material consideration in determining applications and will be used by the Highways Development Management Team in assessing proposals. The HCC PMPDG aligns with the Manual for Streets, a document reviewed by the Association of Chief Fire Officers, providing clarity on emergency access requirements.

STO2.02 – Adoption

The adoption of streets is done on a case by case basis and determined by the Highway Authority in accordance with the HCC PMPDG. Avenues and Neighbourhood Streets are likely to be adopted whilst lower order street types may, if they incorporate a strategic active travel link.

STO2.03 – Social Spaces

Must be at least 2m wide, have a minimum area of 12sqm, include seating at 3 heights as per BS8300-1:2018 and incorporate at least one tree for shading.

STO2.04 – Verges and Landscape Areas

Must incorporate street trees and planting that contribute to ecological enhancements. Mono-cultural grass verges and landscape areas will not be permitted.

STO2.05 – Street Trees

A minimum of two street tree species are required per streets for climate and disease resilience. Street trees may be incorporated in clusters or in a formal row arrangement depending on the context.

STO2.06 – Visitor Cycle Parking Space

Must be provided within 50m of every residential front door.

STO2.07 – Junction Radii

Junction radii on all streets must be minimised using tracking. Vehicles may swing out over the centreline when turning and tracking does not have to follow the kerblines - an approach to be agreed with the Highway Authority early in the design process.

ST02.08 – Inconsiderate Parking

Must be designed out on all street types. Street designs that rely on enforcement to limit illegal and anti-social parking will not be permitted. There are a number of ways this can be achieved including planting, landscaping and minimising carriageway widths.

ST02.09 – Road Signs and Marking

Must be minimised to avoid street clutter.

ST02.10 – Materials and Surfacing

The following table includes appropriate materials for each street type. On streets that require carriageway edging, the edging must be in a different material and/or tone to the main carriageway to give the appearance of narrowing.

BI	Bituminous
LB	Bituminous that must be non-black with an LRV >30.
EB	Enhanced bituminous surfacing with the use of coloured or non-black aggregates to enhance visual quality and create a more distinctive finish.
BP	Block paving that must be non-black with an LRV >30.
PP	Permeable paving that must be non-black with an LRV >30.
SS	Stone setts including cobblestones, granite, sandstone and limestone.
SL	Soft landscaping

	Carriageway	Carriageway Edging	Footways	Social Spaces	On Street Parking	On Plot Parking
ST03 Green Street			BP PP SS	BP PP SL		
ST04 Avenue	BI		BI	BP SS SL	LB EB BP	
ST05 Neighbourhood Street	BI		LB	BP PP SS SL	LB BP	BP PP SS
ST06 Residential Street	BI		LB EB	BP PP SS SL	BP LB	BP PP SS
ST07 Residential Mews	LB EB BP PP SS	BP PP SS			BP PP SS	
ST08 Rear Mews	LB EB BP PP SS	BP PP SS			BP PP SS	BP PP SS
ST09 Spur Lane	BP PP SS			BP PP SS SL	BP PP SS	BP PP SS
ST10 Edge Lane	LB EB BP PP SS	SS			LB EB BP PP SS	BP PP SS

GREEN STREETS

Green Streets are non-motorised routes that prioritise sustainable travel and should be used to create direct routes to and between key green spaces and social infrastructure such as schools. The character of the central open space will be determined by the site context and may incorporate a number of functions such as play, attenuation and nature

STO3.01 – Place Requirements

STO3.01A – Maximum Width	No maximum width. Must be at least 10m between private thresholds.
STO3.01B – Social Spaces	Must be provided at least every 50m.
STO3.01C – Views and Vistas	No coded requirements.
STO3.01D – Landscape	Must incorporate a central landscaped zone with a minimum width of 5m.
STO3.01E – Junctions	No coded requirements.
STO3.01F – Street Trees	Must incorporate at least one street tree per dwelling served.
STO3.01G – Homes Served	No maximum limit.
STO3.01H – Frontage	Must be defined by fronts or sides. Rear elevations onto Green Streets will not be permitted.



Doyle Place, Fairfield Park, Central Bedfordshire [Map Location](#) →

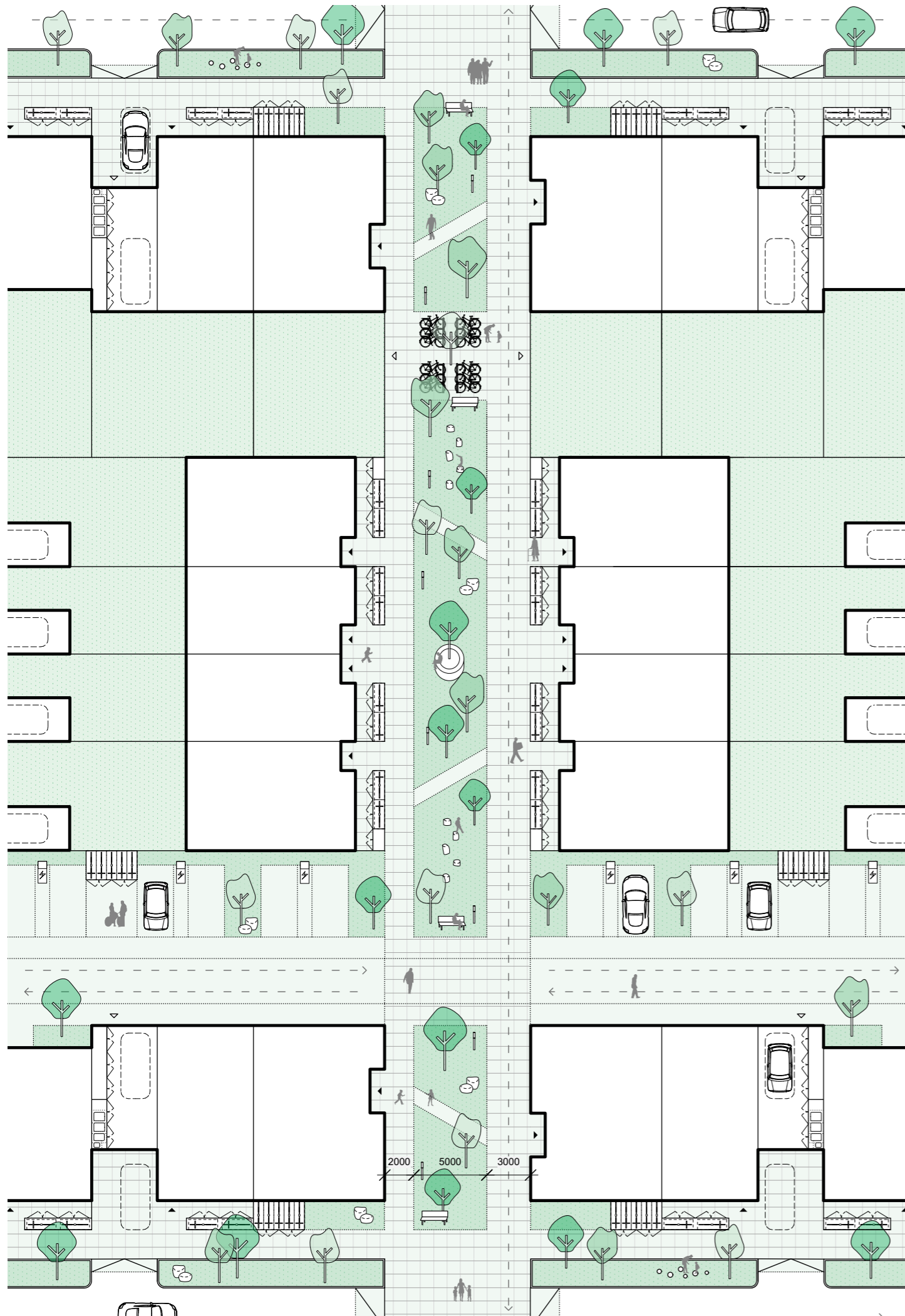

ST03.02 – Movement Requirements

ST03.02A – Pedestrians	Footways on both sides must have a minimum width of 2m. Steps will not be permitted.
ST03.02B – Pedestrian Crossings	Surfaced crossings (appropriate for wheelchair and pram use) must be provided over the central landscape zone at least every 25m.
ST03.02C – Pedestrian Access	No coded requirements.
ST03.02D – Cyclists	Pavement width on one side will vary between 2-3.5m depending on the capacity required for cycling.
ST03.02E – Vehicular Lanes	Not permitted.
ST03.02F – Carriageway	n/a
ST03.02G – Through Traffic	n/a
ST03.02H – Passing Points	n/a
ST03.02I – Service Vehicles	n/a
ST03.02J – Vehicular Speed	n/a
ST03.02K – Junction Forms	n/a
ST03.02L – Junction Spacing	n/a
ST03.02M – Bus Stops	n/a

ST03.03 – Parking Requirements

ST03.03A – On Street Parallel Parking	n/a
ST03.03B – On Street Perpendicular Parking	n/a
ST03.03C – On Plot Parking	n/a
ST03.03D – Visitor Cycle Parking	Must be provided within the central landscape zone.

ST03.04 – Technical Requirements

ST03.04A – HCC PMPDG Classification	P2M1 L2 Sustainable Travel Links
ST03.04B – Street Drainage	Drainage must be attenuated through SuDS such as rain gardens or permeable paving.
ST03.04C – Lighting	Lighting must be incorporated on built form surfaces or in the landscape zone to keep footway widths unobstructed.
ST03.04D – Car Charging	n/a
ST03.04E – Forward Visibility	Forward visibility and visibility splays at junctions must be considered for cycling.
ST03.04F – Speed Restraints	n/a



Hazelmead Cohousing, Birdport, Dorset, Barefoot Architects (2024)
[Map Location →](#)

AVENUES

Avenues are the highest order of street types that will be delivered within developments sites in North Herts. They accommodate non-residential uses, active travel routes and public transport, serving as a key connector within the street network.

STO4.01 – Place Requirements

STO4.01A – Maximum Width	Must be no wider than 18.5m between private thresholds (unless merged with another aspect of public realm).
STO4.01B – Social Spaces	Must be provided at least every 50m on both sides.
STO4.01C – Views and Vistas	Car parking must not terminate the vista at the end of streets that connect on to Avenue streets.
STO4.01D – Landscape	Must have landscape zones on both sides with a minimum width of 2m, accommodating verges, parking, social spaces and street furniture.
STO4.01E – Junctions	No coded requirements.
STO4.01F – Street Trees	Must incorporate one street tree per two homes.
STO4.01G – Homes Served	No maximum limit.
STO4.01H – Frontage	Both sides must be defined by frontage. Gables are permitted on corners at junctions with other streets.



Broadway, Letchworth Garden City [Map Location](#) →

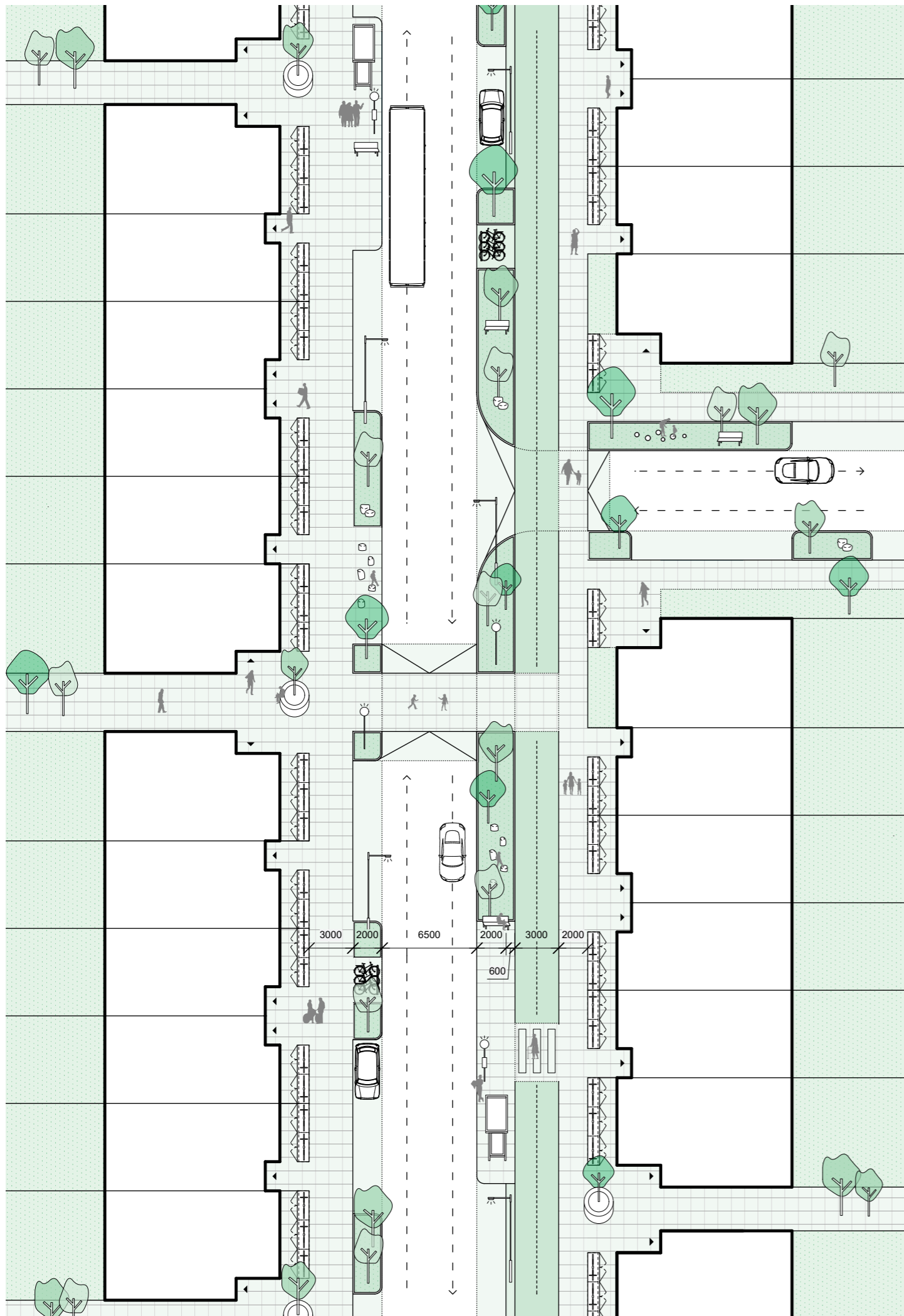

ST04.02 – Movement Requirements

ST04.02A – Pedestrians	Continuous kerbed footways must be provided on both sides. Footway width on cycle lane side must be 2m, width on opposite side must be 3m. Vehicle crossovers will not be permitted. Pedestrian crossing points must be provided at least every 50m.
ST04.02B – Pedestrian Crossings	Zebra and parallel crossings. Copenhagen crossings to lower order streets.
ST04.02C – Pedestrian Access	No coded requirements.
ST04.02D – Cyclists	Cycle lanes must be continuous, two-way and separated from vehicular movement with a minimum width of 3m. There must be a minimum 0.6m buffer between cycle lanes and parking bays to ensure the safety of cyclists against opening doors.
ST04.02E – Vehicular Lanes	Must not comprise more than two vehicular lanes at any point.
ST04.02F – Carriageway	Width must not exceed 6.5m. No centre-line markings permitted.
ST04.02G – Through Traffic	Yes.
ST04.02H – Passing Points	Not required.
ST04.02I – Service Vehicles	Yes.
ST04.02J – Vehicular Speed	20mph
ST04.02K – Junction Forms	Continental/compact roundabouts, signal junctions and priority junctions permitted.
ST04.02L – Junction Spacing	Minimum 20m opposite, 45m adjacent.
ST04.02M – Bus Stops	Bus stops must be on the carriageway. Shelters must be provided without impinging on footway/cycleway widths with a minimum footway depth of 2.5m at bus stops.

ST04.03 – Parking Requirements

ST04.03A – On Street Parallel Parking	Permitted - must be accommodated within the landscape zone with no more than two bays (length 10m) before a landscape section (minimum length 5m). Bays must not be demarcated to facilitate additional spaces for smaller cars.
ST04.03B – On Street Perpendicular Parking	Clusters permitted around focal points (such as Local Centres) but never on opposite sides of the street.
ST04.03C – On Plot Parking	Not permitted.
ST04.03D – Visitor Cycle Parking	Must be located around focal points such as schools, shops and open spaces and incorporated within the landscape zone.

ST04.04 – Technical Requirements

ST04.04A – HCC PMPDG Classification	P2M2 L2 Local Access
ST04.04B – Street Drainage	Street drainage must be attenuated through SuDS such as rain gardens or permeable paving.
ST04.04C – Lighting	Lighting must be on columns and located within landscape zones. Part night lighting can be used to ensure safety in rural or ecologically sensitive areas.
ST04.04D – Car Charging	Must be placed within with landscape zones or within the adjacent buffer to ensure cycleway and footway widths are not reduced.
ST04.04E – Forward Visibility	Minimum 25m
ST04.04F – Speed Restraints	Maximum 80m between speed restraints. Acceptable speed restraints include pinch points, raised tables and chicanes.



Eddington Avenue, Cambridge, Pollard Thomas Edwards (2024) [Map Location](#) →

NEIGHBOURHOOD STREETS

Neighbourhood Streets are well-planted with generous landscaped areas on both sides that also integrate street furniture, trees and parking. Neighbourhood Streets will form part of the active travel network, accommodating cycling on the carriageway or on shared use footways.

ST05.01 – Place Requirements

ST05.01A – Maximum Width	Must be no wider than 13.5m between private thresholds (unless merged with another aspect of public realm).
ST05.01B – Social Spaces	Must be provided at every junction with another street.
ST05.01C – Views and Vistas	Car parking must not terminate the vista at the end of streets that connect on to Neighbourhood Streets.
ST05.01D – Landscape	Must have landscape zones on both sides with a minimum width of 2m, accommodating verges, parking, social spaces and street furniture.
ST05.01E – Junctions	Refer to ST05.01B Social Spaces.
ST05.01F – Street Trees	Must incorporate one street tree per two homes.
ST05.01G – Homes Served	No maximum limit.
ST05.01H – Frontage	Both sides must be defined by frontage. Gables are permitted on corners at junctions with other streets.

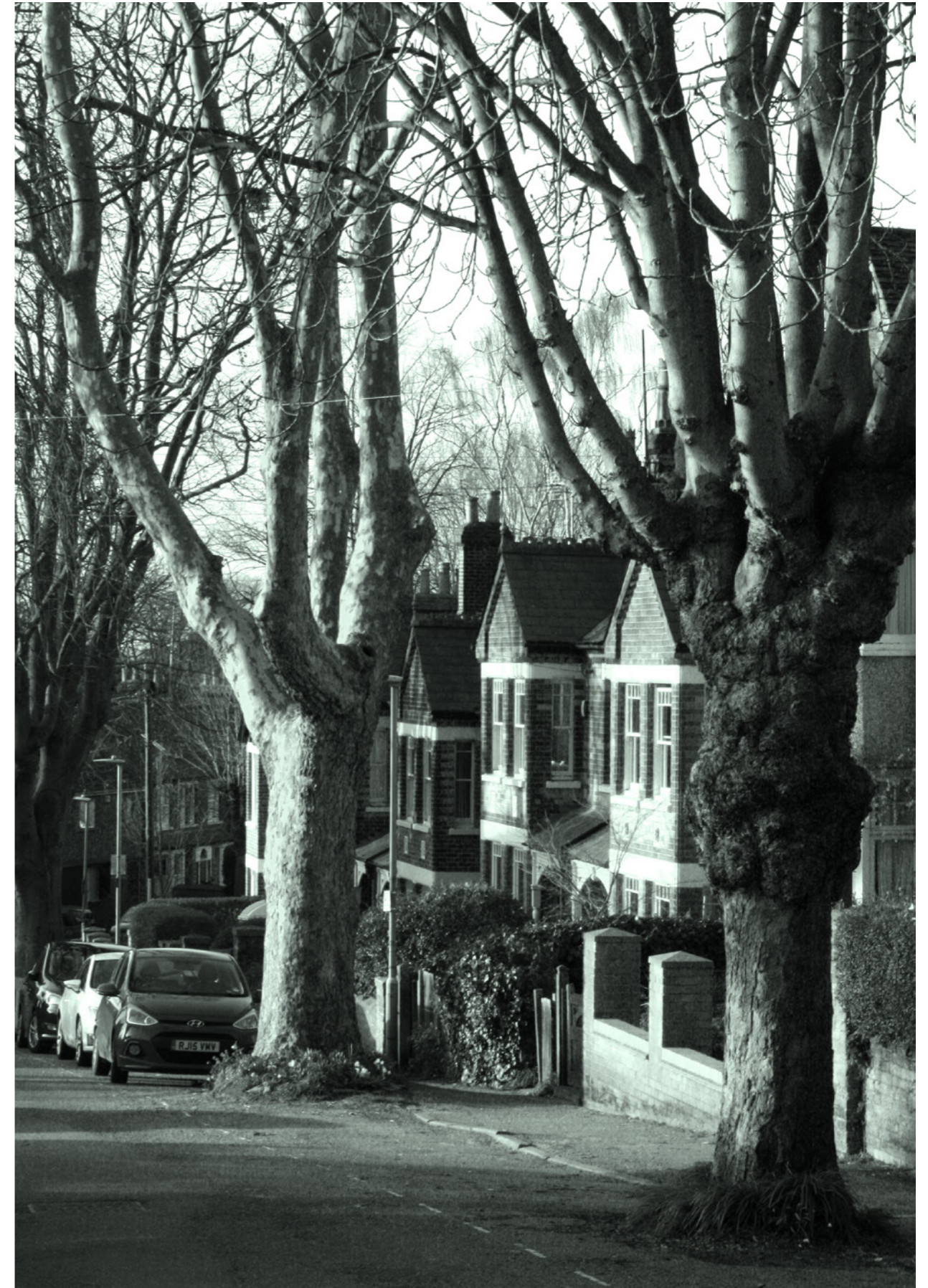

Chiltern Road, Hitchin [Map Location](#) →

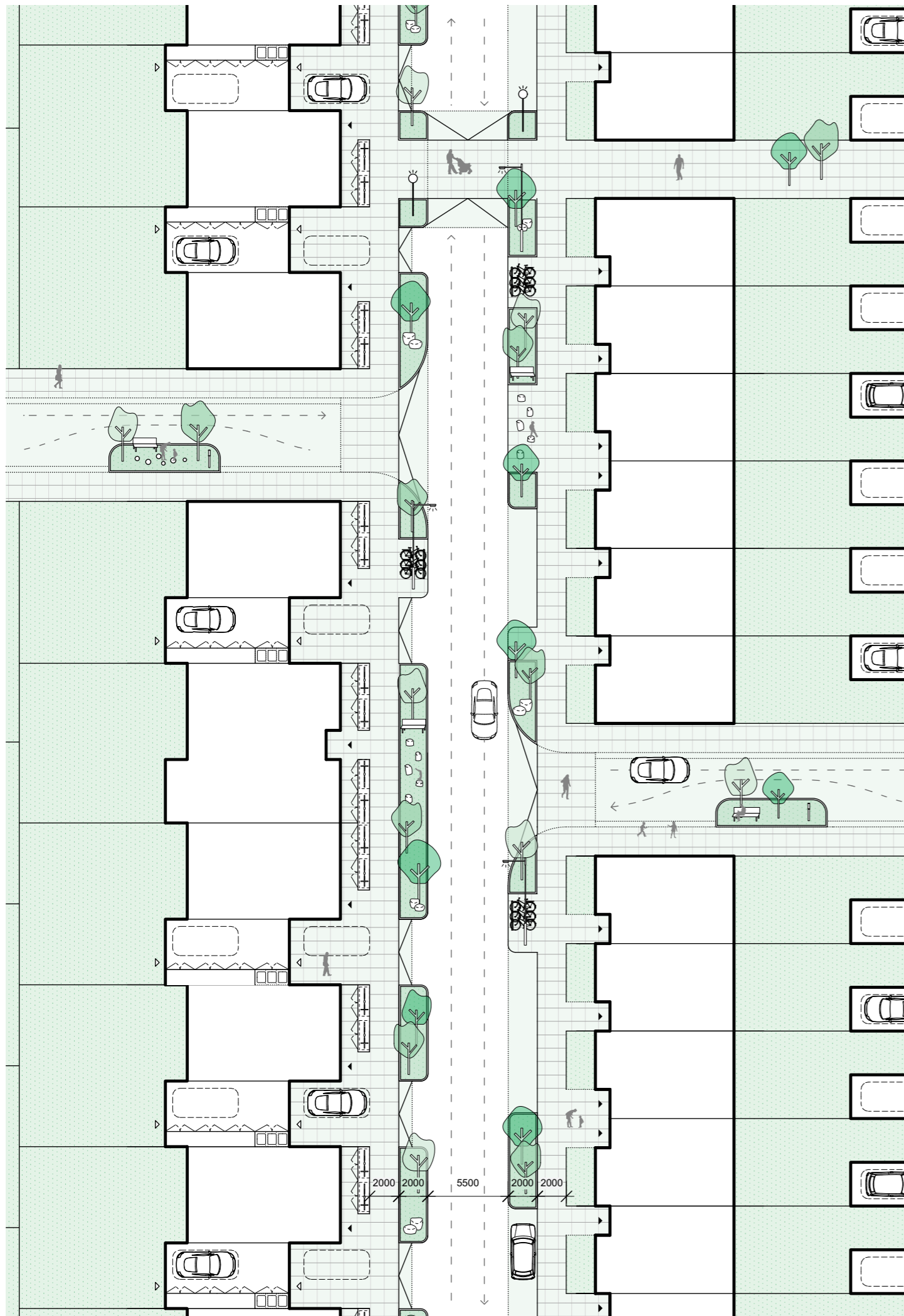

ST05.02 – Movement Requirements

ST05.02A – Pedestrians	Continuous kerbed footways must be provided on at least one side of the street where vehicle crossovers are not permitted. Footways must have a minimum unobstructed width of 2m.
ST05.02B – Pedestrian Crossings	No coded requirements.
ST05.02C – Pedestrian Access	No coded requirements.
ST05.02D – Cyclists	Accommodated on the carriageway if volumes and speeds of vehicular traffic are low enough in line with LTN 1/20 Table 4.1. If not, footways must be 3m in width to accommodate shared use.
ST05.02E – Vehicular Lanes	Must not comprise more than two vehicular lanes at any point.
ST05.02F – Carriageway	Width must not exceed 5.5m. No centre-line markings permitted.
ST05.02G – Through Traffic	Yes.
ST05.02H – Passing Points	Not required.
ST05.02I – Service Vehicles	Yes.
ST05.02J – Vehicular Speed	20mph
ST05.02K – Junction Forms	Continental and priority junctions permitted.
ST05.02L – Junction Spacing	Minimum 20m opposite, 45m adjacent.
ST05.02M – Bus Stops	May be accommodated within landscape zone.

ST05.03 – Parking Requirements

ST05.03A On Street Parallel Parking	Permitted - must be accommodated within landscape zone with no more than three bays before a landscape section (minimum length 5m). Bays must not be demarcated to facilitate additional spaces for smaller cars.
ST05.03B On Street Perpendicular Parking	Clusters permitted but never on opposite sides of the street. Clusters must not accommodate more than 12 parking spaces, must not have more than 4 bays before a landscape section (minimum dimensions 2x6m) and must be a minimum of 50m apart to prevent the over-dominance of perpendicular parking.
ST05.03C On Plot Parking	Permitted on one side of the street.
ST05.03D Visitor Cycle Parking	Must be provided within landscape zone or social spaces.

ST05.04 – Technical Requirements

ST05.04A – HCC PMPDG Classification	P2M2 L2 Local Access
ST05.04B – Street Drainage	Street drainage must be attenuated through SuDS such as rain gardens or permeable paving.
ST05.04C – Lighting	Lighting must be on columns and located within landscape zones.
ST05.04D – Car Charging	Accommodated on plot, in between parallel parking bays or at the front of perpendicular bays.
ST05.04E – Forward Visibility	Minimum 25m
ST05.04F – Speed Restraints	Maximum 80m between speed restraints. Acceptable speed restraints include pinch points, raised tables and chicanes.



Haslips Close, Goldsmith Street, Norwich, Mikhail Riches Architects (2019)
[Map Location →](#)

RESIDENTIAL STREETS

Residential Streets are likely to make up the majority of the street network within development sites in North Herts. They are less formal than Neighbourhood Streets with level footways and pinch points to reduce vehicle speeds.

STO6.01 – Place Requirements

STO6.01A – Maximum Width	Must be no wider than 9.1m between private thresholds (unless merged with another aspect of public realm).
STO6.01B – Social Spaces	Must be provided at every junction with another street.
STO6.01C – Views and Vistas	Car parking must not terminate the vista at the end of streets that connect on to Residential Streets.
STO6.01D – Landscape	A landscape zone (minimum dimensions 2x6m) must be provided every 35m.
STO6.01E – Junctions	Refer to 06.01B Social Spaces.
STO6.01F – Street Trees	Must incorporate one street tree per two homes.
STO6.01G – Homes Served	Maximum 300 homes per km.
STO6.01H – Frontage	At least one side must be defined by frontage. Gables are acceptable if Residential Street is providing access to Spur Streets.



Field Lane, Letchworth Garden City [Map Location](#) →

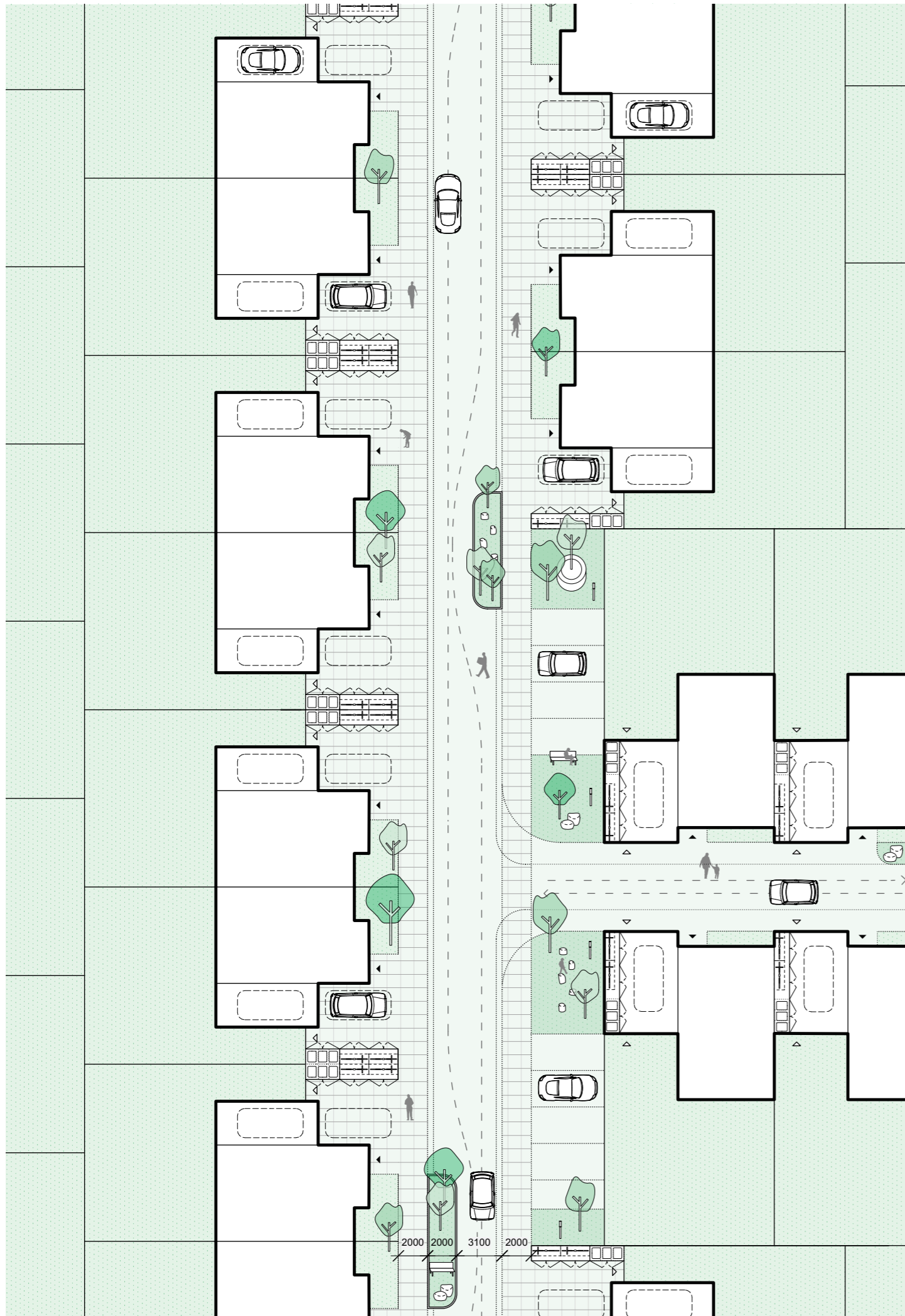

ST06.02 – Movement Requirements

ST06.02A – Pedestrians	Level surface footways with a contrasting strip between the footway and carriageway. Half height kerbs are also permitted. Must have a minimum unobstructed width of 2m.
ST06.02B – Pedestrian Crossings	No coded requirements.
ST06.02C – Pedestrian Access	No coded requirements.
ST06.02D – Cyclists	Accommodated on the carriageway if volumes and speeds of vehicular traffic are low enough in line with LTN 1/20 Table 4.1. If not, footways must be 3m in width to accommodate shared use.
ST06.02E – Vehicular Lanes	Must not comprise more than two vehicular lanes at any point.
ST06.02F – Carriageway	Width must not exceed 5.5m. No centre-line markings permitted.
ST06.02G – Through Traffic	Through traffic and filtered permeability permitted.
ST06.02H – Passing Points	Not required.
ST06.02I – Service Vehicles	Yes.
ST06.02J – Vehicular Speed	20mph
ST06.02K – Junction Forms	Simple priority only.
ST06.02L – Junction Spacing	Minimum 20m opposite, 33m adjacent.
ST06.02M – Bus Stops	Not accommodated.

ST06.03 – Parking Requirements

ST06.03A – On Street Parallel Parking	Permitted for unallocated visitor spaces. No more than two bays before a landscape section (minimum dimensions 2x6m). Bays must not be demarcated to facilitate additional spaces for smaller cars.
ST06.03B – On Street Perpendicular Parking	Permitted for unallocated visitor spaces. Clusters must not accommodate more than 8 parking spaces, must not have more than 4 bays before a landscape section (minimum dimensions 2x6m) and must be a minimum of 50m apart to prevent the over-dominance of perpendicular parking.
ST06.03C – On Plot Parking	Permitted on both sides of the street.
ST06.03D – Visitor Cycle Parking	Must be provided within landscape areas or social spaces.

ST06.04 – Technical Requirements

ST06.04A – HCC PMPDG Classification	P2M1 L2 Local Access
ST06.04B – Street Drainage	Street drainage must be attenuated through SuDS such as rain gardens or permeable paving.
ST06.04C – Lighting	Lighting must be on columns and located within landscape areas.
ST06.04D – Car Charging	Accommodated on plot, in between parallel parking bays or at the front of perpendicular bays.
ST06.04E – Forward Visibility	Minimum 33m
ST06.04F – Speed Restraints	Maximum 70m between speed restraints. Acceptable speed restraints include pinch points, raised tables and chicanes.



Royal Way, Great Kneighton, Proctor and Matthews Architects (2019)
[Map Location →](#)

RESIDENTIAL MEWS

Residential Mews are well-enclosed short runs of streets, appropriate in more urban locations. They rely on integral parking and linked built form typologies to create an intimate character. Surfaces are shared as vehicular movements are very low.

ST07.01 – Place Requirements

ST07.01A – Maximum Width	Must be no wider than 6m between private thresholds (unless merged with another aspect of public realm).
ST07.01B – Social Spaces	Must be provided at access points.
ST07.01C – Views and Vistas	No coded requirements.
ST07.01D – Landscape	Landscaped build outs must be used as a traffic calming measure. Each area must contain at least one tree.
ST07.01E – Junctions	Refer to 07.01B Social Spaces.
ST07.01F – Street Trees	Must incorporate one street tree per three homes.
ST07.01G – Homes Served	Maximum 50 dwellings with a through route and 25 dwellings without.
ST07.01H – Frontage	Must be defined on both sides by continuous built form on ground floor. Must be defined by frontage - gables only permitted at access points.



Christopher Court, Ware [Map Location](#) →

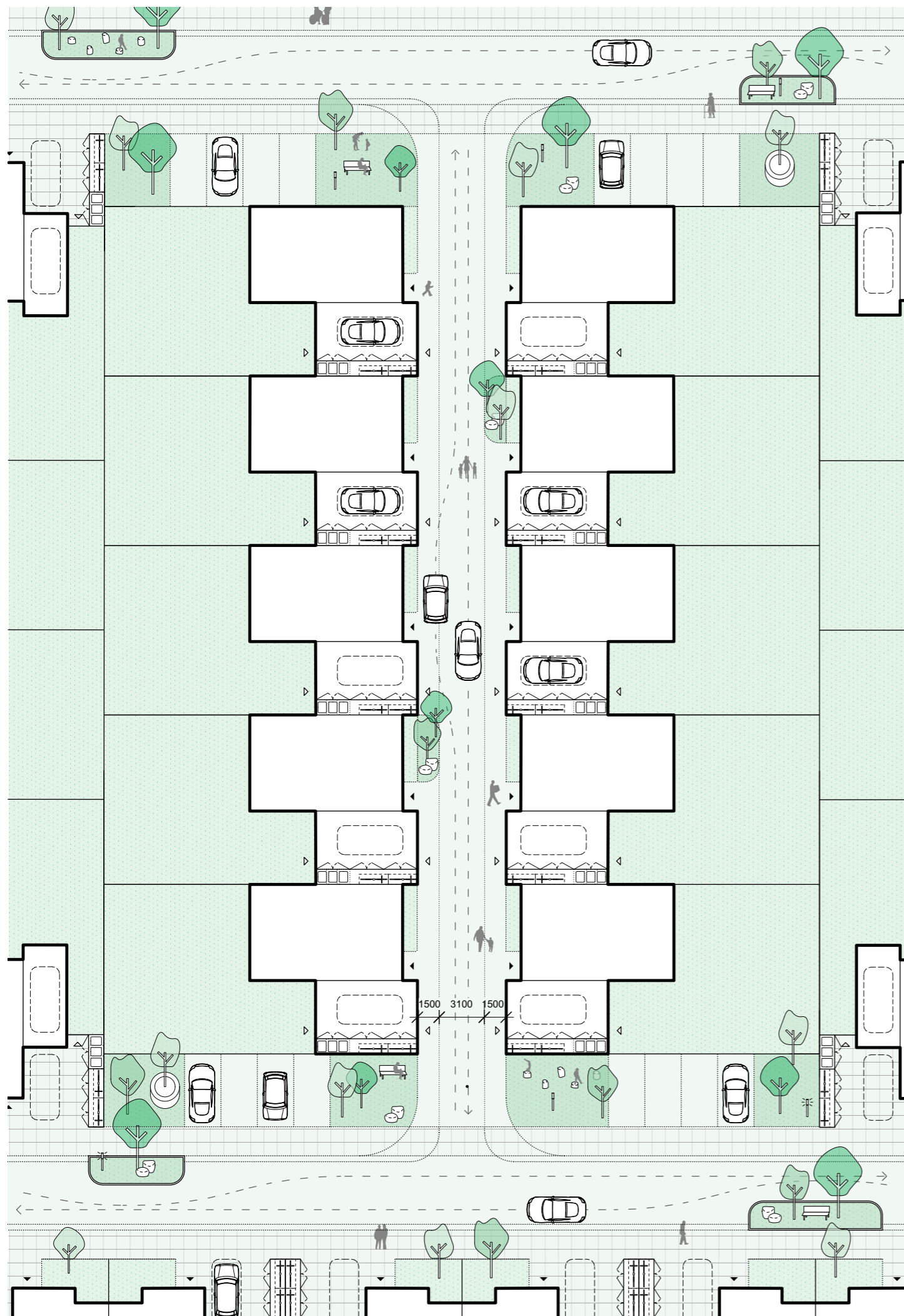

ST07.02 – Movement Requirements

ST07.02A – Pedestrians	Accommodated on the carriageway.
ST07.02B – Pedestrian Crossings	Copenhagen crossings at junctions with Avenues and Neighbourhood Streets.
ST07.02C – Pedestrian Access	No coded requirements.
ST07.02D – Cyclists	Accommodated on the carriageway.
ST07.02E – Vehicular Lanes	Must not exceed one vehicular lane at any point.
ST07.02F – Carriageway	Width must not exceed 6m and must include 1.5m edging on both sides. Carriageway must narrow to 4.5m to slow vehicles.
ST07.02G – Through Traffic	Through traffic and filtered permeability permitted. Turning heads (if required) must be carefully integrated and provide public realm benefits.
ST07.02H – Passing Points	Not required.
ST07.02I – Service Vehicles	Yes.
ST07.02J – Vehicular Speed	10mph
ST07.02K – Junction Forms	Simple priority only.
ST07.02L – Junction Spacing	n/a
ST07.02M – Bus Stops	Not accommodated.

ST07.03 – Parking Requirements

ST07.03A – On Street Parallel Parking	Not permitted.
ST07.03B – On Street Perpendicular Parking	Not permitted.
ST07.03C – On Plot Parking	Permitted - must be accommodated within garages or car ports to ensure continuous built form on ground floor on both sides.
ST07.03D – Visitor Cycle Parking	Must be provided within landscape zones or at access junctions.

ST07.04 – Technical Requirements

ST07.04A – HCC PMPDG Classification	P3M1 Mews Streets
ST07.04B – Street Drainage	Street drainage must be attenuated through permeable paving or a flush channel at the carriageway edge.
ST07.04C – Lighting	Lighting must be on columns or bollards within landscape areas or surface mounted on built form.
ST07.04D – Car Charging	Accommodated on plot.
ST07.04E – Forward Visibility	Minimum 25m
ST07.04F – Speed Restraints	Maximum 70m between speed restraints. Acceptable speed restraints include pinch points and chicanes.



Henslow Mews, Accordia, Cambridge, Alison Brooks Architects with Maccreanor Lavington Architects and Feilden Clegg Bradley Studios (2009) [Map Location](#) →

REAR MEWS

Rear Mews will typically be found to the rear of Avenues, Green Streets and Neighbourhood Streets to accommodate vehicular access for properties fronting these routes. They are well-enclosed and can accommodate small pocket green spaces.

STO8.01 – Place Requirements

STO8.01A – Maximum Width	No coded requirements.
STO8.01B – Social Spaces	Not required.
STO8.01C – Views and Vistas	All views into Rear Mews must be terminated by landscaping and/or a tree. Views terminated by parking will not be permitted.
STO8.01D – Landscape	No coded requirements.
STO8.01E – Junctions	Vehicular entry points must be softened by a tree on at least one side of the junction.
STO8.01F – Street Trees	Minimum one tree per dwelling fronting the street.
STO8.01G – Homes Served	Maximum 50 dwellings.
STO8.01H – Frontage	Must be fronted by a minimum of four dwellings.



Acorn Mews, Baldock [Map Location](#) →

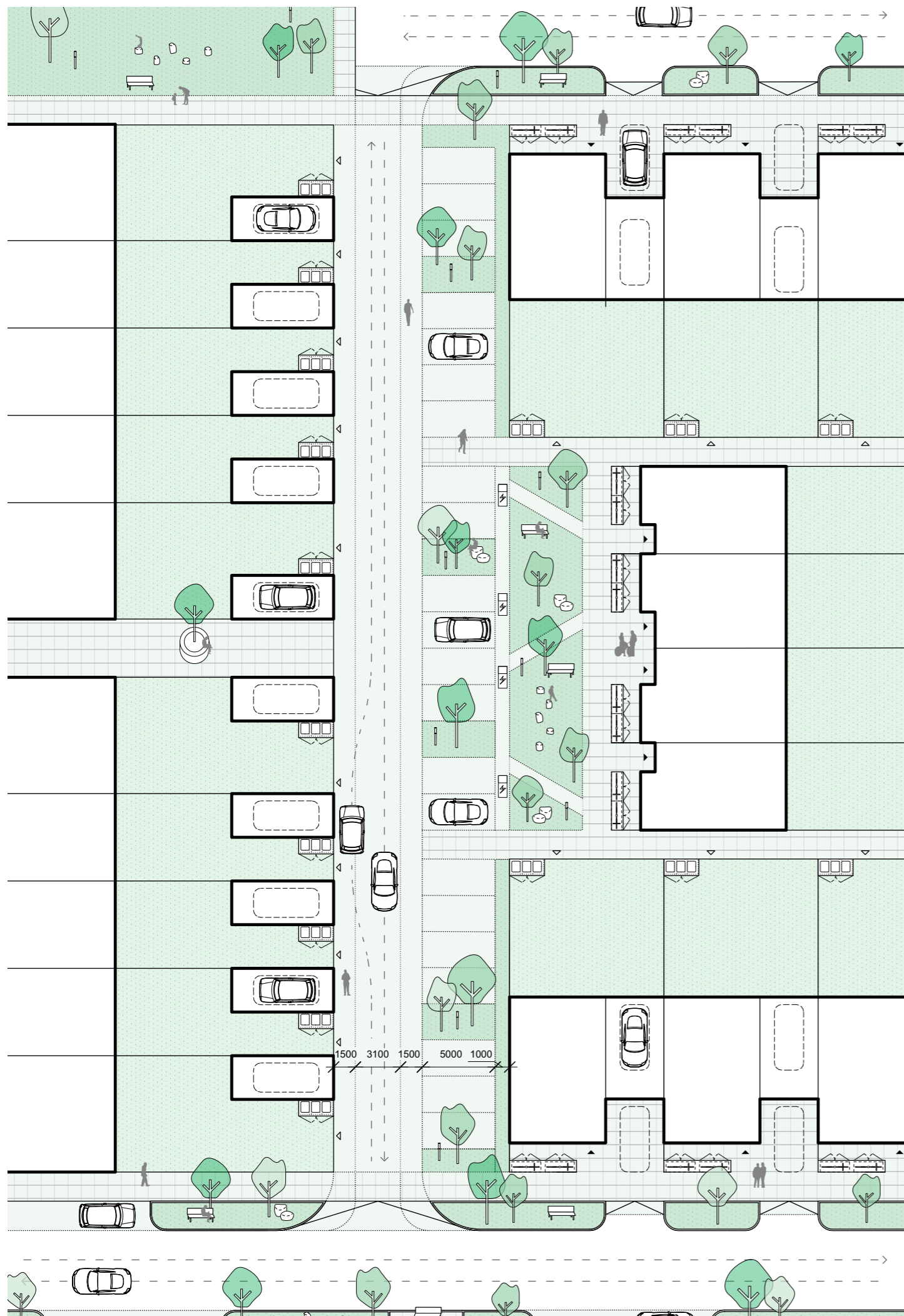

ST08.02 – Movement Requirements

ST08.02A – Pedestrians	Accommodated on the carriageway.
ST08.02B – Pedestrian Crossings	n/a
ST08.02C – Pedestrian Access	Must incorporate a minimum of three pedestrian access points. Access routes must be at least 2m wide and directly overlooks by at least two windows at ground floor level.
ST08.02D – Cyclists	Accommodated on the carriageway.
ST08.02E – Vehicular Lanes	Must not exceed one vehicular lane at any point.
ST08.02F – Carriageway	Width must not exceed 6m and must include 1.5m edging on both sides.
ST08.02G – Through Traffic	Yes - turning heads not permitted.
ST08.02H – Passing Points	Not required.
ST08.02I – Service Vehicles	Yes - through a one-way system.
ST08.02J – Vehicular Speed	10mph
ST08.02K – Junction Forms	Simple priority only.
ST08.02L – Junction Spacing	n/a
ST08.02M – Bus Stops	Not accommodated.

ST08.03 – Parking Requirements

ST08.03A – On Street Parallel Parking	Permitted - no more than 3 bays before a landscape area (minimum dimensions 2x6m).
ST08.03B – On Street Perpendicular Parking	Permitted - no more than 4 bays before a landscape area (minimum dimensions 2x6m). Bays must never be opposite each other on both sides of the street.
ST08.03C – On Plot Parking	Permitted.
ST08.03D – Visitor Cycle Parking	Must be provided within landscape areas or at access junctions.

ST08.04 – Technical Requirements

ST08.04A – HCC PMPDG Classification	P3M1 Mews Streets
ST08.04B – Street Drainage	Street drainage must be attenuated through permeable paving or a flush channel at the carriageway edge.
ST08.04C – Lighting	Lighting must be on columns or bollards within landscape areas or surface mounted on built form.
ST08.04D – Car Charging	Accommodated on plot, in between parallel parking bays or at the front of perpendicular bays.
ST08.04E – Forward Visibility	Minimum 25m
ST08.04F – Speed Restraints	Maximum 70m between speed restraints. Acceptable speed restraints include pinch points and chicanes.



Langerak, Utrecht, Maccreeanor Lavington Architects (2008), [Map Location](#) →

SPUR LANES

Spur Lanes are short streets that run perpendicular to the edge of the site and provide access to small groups of dwellings. They are most appropriate when responding to ecologically sensitive edges or rural contexts due to the informal arrangement of buildings (see SS03).

ST09.01 – Place Requirements

ST09.01A – Maximum Width	No coded requirements.
ST09.01B – Social Spaces	Must accommodate at least one Social Space.
ST09.01C – Views and Vistas	Must frame views out into the landscape. Spur Lanes terminated by built form will not be permitted.
ST09.01D – Landscape	No coded requirements.
ST09.01E – Junctions	No coded requirements.
ST09.01F – Street Trees	Minimum one tree per home fronting the street.
ST09.01G – Homes Served	Maximum 5 dwellings.
ST09.01H – Frontage	Must be fronted by a minimum of three dwellings.



Abode, Great Kneighton, Proctor and Matthews Architects (2019) [Map Location](#) →

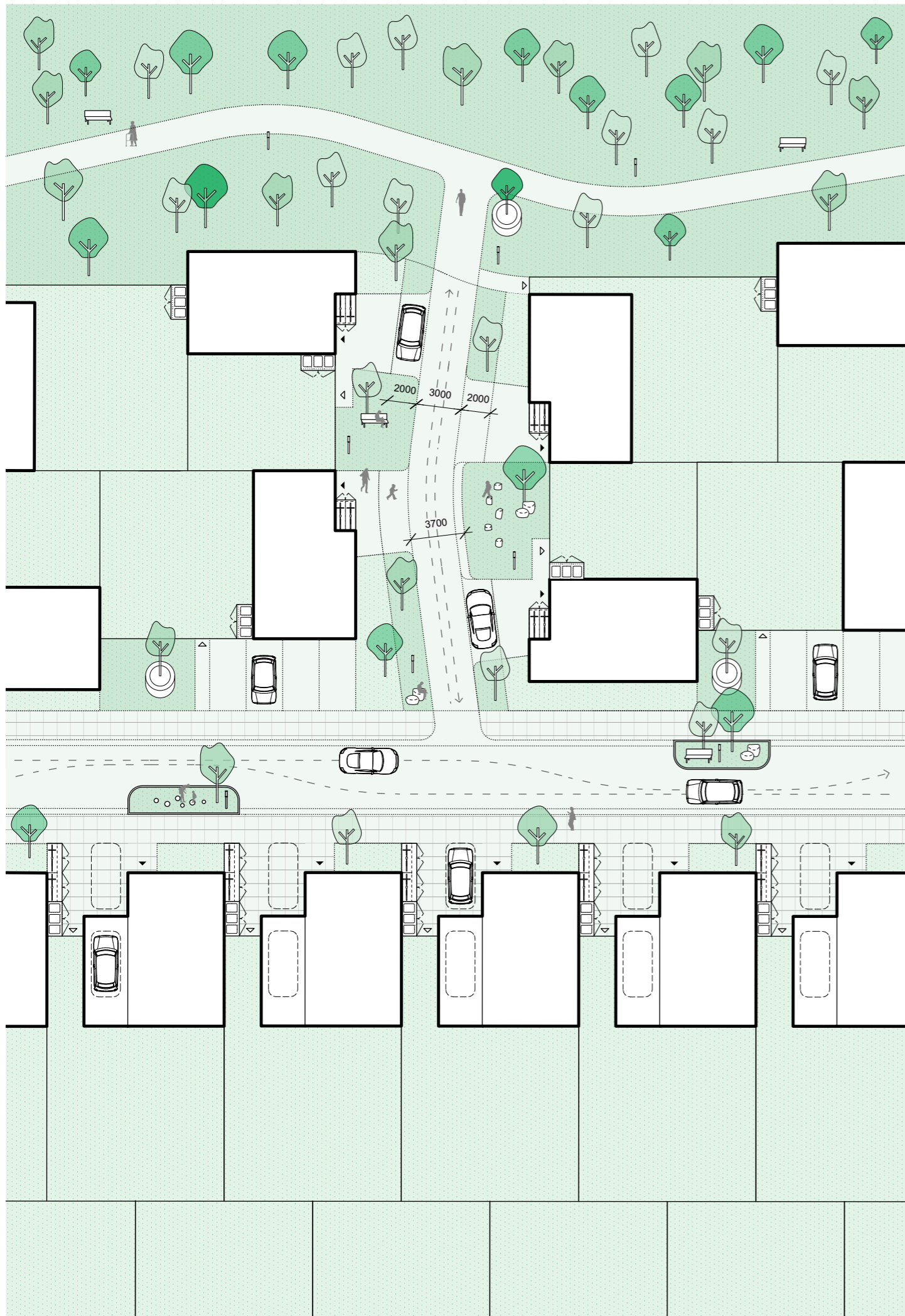

ST09.02 – Movement Requirements

ST09.02A – Pedestrians	Accommodated on the carriageway.
ST09.02B – Pedestrian Crossings	n/a
ST09.02C – Pedestrian Access	No coded requirements.
ST09.02D – Cyclists	Accommodated on the carriageway.
ST09.02E – Vehicular Lanes	Must not exceed one vehicular lane at any point.
ST09.02F – Carriageway	Width must not exceed 3m.*
ST09.02G – Through Traffic	Not permitted.
ST09.02H – Passing Points	Not required.
ST09.02I – Service Vehicles	No - length of Spur Street is limited to 30m due to maximum resident drag distances (see BF10).
ST09.02J – Vehicular Speed	10mph
ST09.02K – Junction Forms	Simple priority only.
ST09.02L – Junction Spacing	n/a
ST09.02M – Bus Stops	Not accommodated.

*The Association of Chief Fire Officers has clarified a 3.7m carriageway (kerb to kerb) is required for operating space at the scene of a fire. The access route could be reduced to 2.75m over short distances, provided the pump appliance can get to within 45m of dwelling entrances, to reach a fire.

ST09.03 – Parking Requirements

ST09.03A – On Street Parallel Parking	Permitted - no more than 3 bays before a landscape area (minimum dimensions 2x6m).
ST09.03B – On Street Perpendicular Parking	Permitted - no more than 4 bays before a landscape area (minimum dimensions 2x6m).
ST09.03C – On Plot Parking	Permitted.
ST09.03D – Visitor Cycle Parking	Must be provided within landscape areas or at access junctions.

ST09.04 – Technical Requirements

ST09.04A – HCC PMPDG Classification	P3M1 Informal Streets
ST09.04B – Street Drainage	Street drainage must be attenuated through rain gardens, permeable paving or a flush channel at the centre of the carriageway.
ST09.04C – Lighting	Lighting must be on columns or bollards within landscape areas or surface mounted on built form.
ST09.04D – Car Charging	Accommodated on plot, in between parallel parking bays or at the front of perpendicular bays.
ST09.04E – Forward Visibility	Minimum 11m
ST09.04F – Speed Restraints	Not required.



EDGE LANES

Edge Lanes are most appropriate at the edges of development and run parallel to the site boundary. These streets are most appropriate when they front open spaces creating a sense of passive surveillance. It is important they provide continuous pedestrian permeability.

ST10.01 – Place Requirements

ST10.01A – Maximum Width	No coded requirements.
ST10.01B – Social Spaces	No coded requirements.
ST10.01C – Views and Vistas	Access points into Edge Lanes must frame views out into the landscape. Views terminated by built form will not be permitted.
ST10.01D – Landscape Zones	No coded requirements.
ST10.01E – Junctions	Junctions into Edge Lanes must be framed by a tree on each side of the street.
ST10.01F – Street Trees	No coded requirements - trees to be incorporated into adjoining open space.
ST10.01G – Homes Served	Maximum 50 dwellings.
ST10.01H – Frontage	The majority of built form (>50%) must front the Edge Lane. Sides and rears fronting the Edge Lane will be permitted to add variety in rural locations.

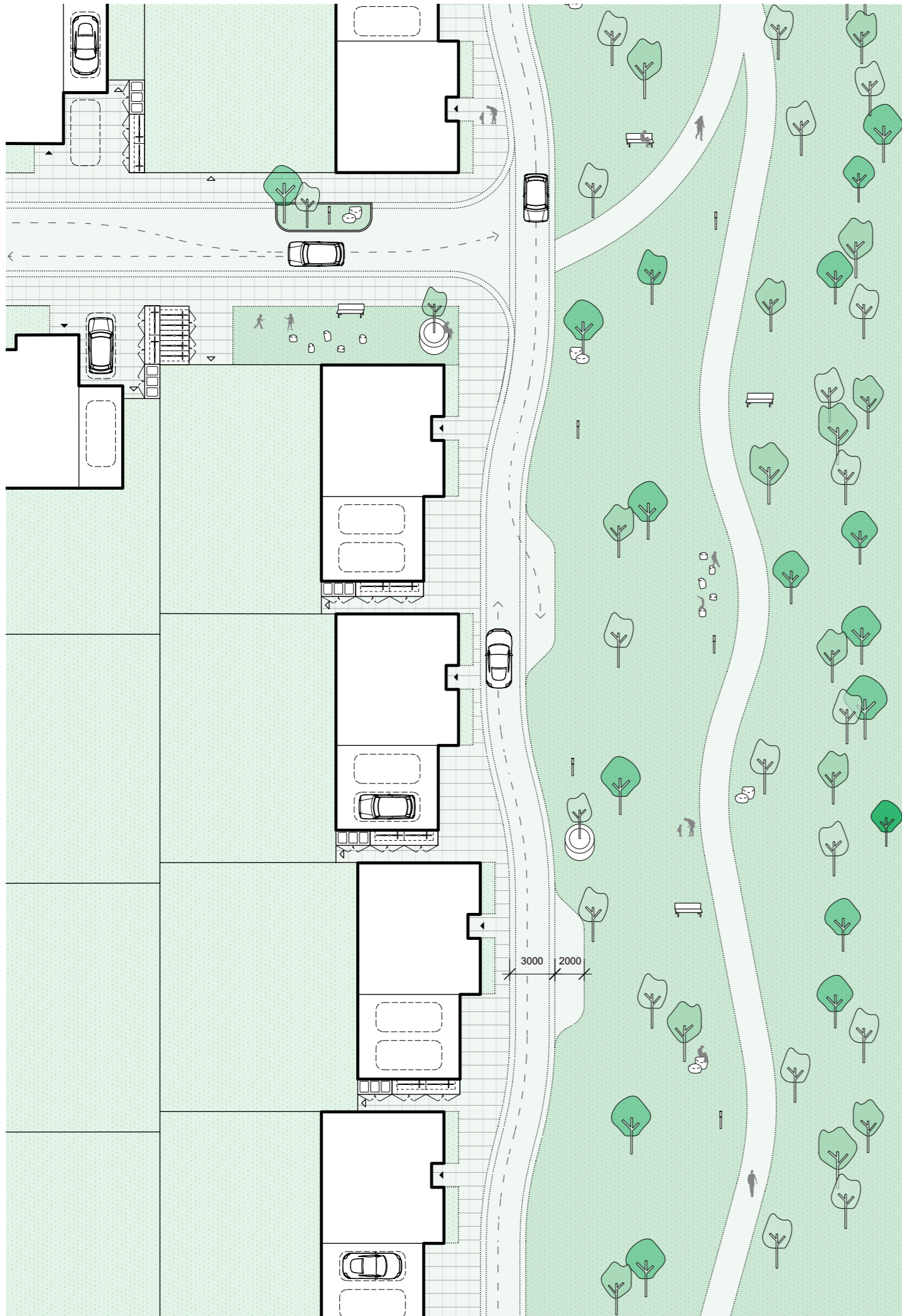

ST10.02 – Movement Requirements

ST10.02A – Pedestrians	Accommodated on the carriageway.
ST10.02B – Pedestrian Crossings	n/a
ST10.02C – Pedestrian Access	No coded requirements.
ST10.02D – Cyclists	Accommodated on the carriageway.
ST10.02E – Vehicular Lanes	Must not exceed one vehicular lane at any point (apart from at passing points).
ST10.02F – Carriageway	Width must not exceed 3m.* Geometry of the carriageway edge must be gentle to reflect the rural character - hammerheads and constant radius curves will not be permitted.
ST10.02G – Through Traffic	Typically no - permitted modal filters include raised planters and trees. Garages as modal filters will not be permitted as they do not provide visual connectivity for pedestrians.
ST10.02H – Passing Points	Required if Edge Lane is longer than 11m. Passing point must be provided halfway through gentle widening of carriageway.
ST10.02I – Service Vehicles	If required, turning heads will not be permitted and must be designed out through one-way servicing route.
ST10.02J – Vehicular Speed	10mph
ST10.02K – Junction Forms	Simple priority only.
ST10.02L – Junction Spacing	n/a
ST10.02M – Bus Stops	Not accommodated.

*The Association of Chief Fire Officers has clarified a 3.7m carriageway (kerb to kerb) is required for operating space at the scene of a fire. The access route could be reduced to 2.75m over short distances, provided the pump appliance can get to within 45m of dwelling entrances, to reach a fire.

ST10.03 – Parking Requirements

ST10.03A – On Street Parallel Parking	Permitted - no more than two bays (length 10m).
ST10.03B – On Street Perpendicular Parking	Not permitted.
ST10.03C – On Plot Parking	Permitted - widening of carriageway to incorporate reversing distances will not be permitted. Must be designed out through widening bays or providing generous front gardens.
ST10.03D – Visitor Cycle Parking	Must be provided within open space or at access junctions.

ST10.04 – Technical Requirements

ST10.04A – HCC PMPDG Classification	P3M1 Mews
ST10.04B – Street Drainage	Street drainage must be attenuated through permeable paving or a flush channel at the centre of the carriageway.
ST10.04C – Lighting	Lighting must be surface mounted on built form or on low-level bollards to the open space side.
ST10.04D – Car Charging	Accommodated on plot or between parallel parking bays.
ST10.04E – Forward Visibility	Minimum 11m
ST10.04F – Speed Restraints	Not required.



Holmead Walk, Dorchester (2001) [Map Location](#) →